



Hight PF flicker free LED Driver—LKAD021F

—产品特性/Feature—



- 100-264VAC(50/60Hz)输入/ 100-264VAC(50/60Hz) Input
- 隔离方案, 不调光/Isolated,non-dimmable driver;
- 高效率、高功率因素、无频闪、稳定性好/ Hight efficiency,hight PF,non-flicker,good steady;
- 短路保护,开路保护,过流保护,过温保护/ Short circuit,open LED,over current and over temperature protection;
- 自然风冷/ cooling by free air convection;
- 100%满载老化测试/ 100% full load burn-in test;
- 独立外置, Class II 恒流类型/ Independent, Class II constant current type;
- 防护等级 IP20/ degree of protection IP20;
- 适用于面板灯/天花灯/筒灯等照明应用/ suitable for LED lighting,ceiling light,down light and panel light;
- 3年质保期/ 3 years warranty.



产品参数/Specification

Model	LKAD021F	
输入 Input	AC电压范围/AC Voltage range	100-264V
	频率/Frequency	50/60hz
	谐波/THD	---
	功率因数/Power factor	0.98/230VAC
输出 Output	额定电压/Rated voltage	40V
	空载电压/No-load Voltage	48V
	DC电压范围/DC voltage range	25-40V
	DC电流范围/DC current range	630-670mA
	电流精度/Current precision	(+/-)3%
	额定功率/Rated power	26W
	开机延时/Setup Time	≤0.5s/230VAC
使用环境 Environment Requirements	工作温度/湿度要求 Operating Temp./RH	-30~+45℃/20~95%
	储存温度, 湿度要求 Storage Temp./RH	-40~+80℃/10~95%
安全和电磁兼容	认证编号/Certificate	---
其他	尺寸/Size	L110*W42*H24mm
	重量/Net weight	---

测试数据/Test data

输入电压 Input voltage (Vac)	输入电流 Input current (mA)	输入功率 Input power (W)	功率因数 PF	输出电压 Output voltage (Vdc)	输出电流 Output current (mA)	输出功率 Output Power (W)	转换效率 Efficiency (%)
100	196.50	19.92	0.992	25.00	666	16.65	83.6%
	277.80	27.97	0.996	36.00	659	23.72	84.8%
	305.70	30.92	0.998	40.00	655	26.20	84.7%
230	84.43	18.69	0.950	25.00	640	16.00	85.6%
	117.50	26.68	0.976	36.00	645	23.22	87.0%
	130.10	29.58	0.981	40.00	647	25.88	87.5%
264	75.49	18.54	0.924	25.00	631	15.78	85.1%
	103.90	26.45	0.963	36.00	638	22.97	86.8%
	114.20	29.31	0.970	40.00	640	25.60	87.3%

产品尺寸图/ Product Size Diagram

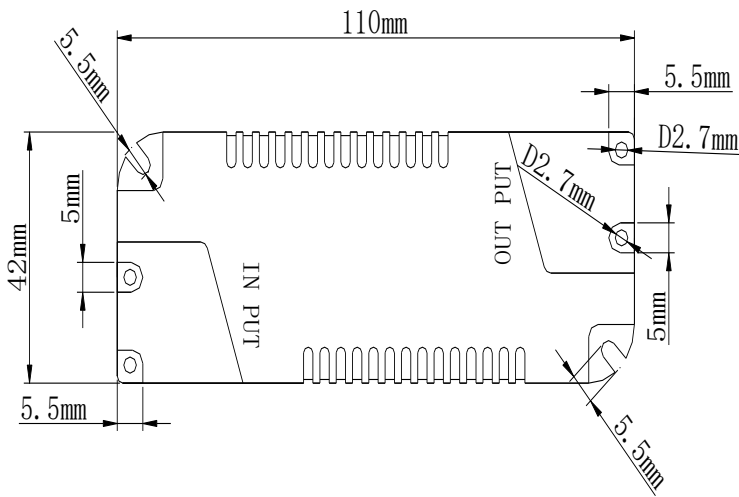

产品接线示意图/ Product Connection Diagram



备注/Note:

- 所有没提及到的参数都是在230V输入，额定负载和在周围温度为25℃的情况下测试的；
All parameters NOT specially mentioned are measured at 230VAC input, rated load and 25 of ambient temperature;
- 本驱动电源是作为一个部件与最终的设备结合进行操作的。因为EMC的性能在电源完全安装后会受到影响，因此最终设备制造商在完成安装后必须重新获取EMC指示认定。
The LED driver is considered as a component that will be operated in combination with final equipment. Since EMC performance will be affected by the complete installation, the final equipment manufacturers must re-qualify EMC Directive on the complete installation again.

3. 可以直接与LEDs连接，但不适宜与额外的驱动电源使用；

Direct connecting to LEDs is suggested, but is not suitable for using additional drivers.

4. 为了满足在灯具安装中最后的Erp校准要求，本驱动电源只能在一个不是永久地连接在交流干线的开关后面使用。

To fulfill requirements of the latest ErP regulation for lighting fixtures, this LED power supply can only be used behind a switch without permanently connect to the mains.

东莞市领冠半导体照明有限公司

Dongguan Linkuan Semiconductor Lighting Co.,Ltd

地 址：广东省东莞市万江区大莲塘工业区3号

Address: NO.3 Building, Daliantang Industrial Park,
Wanjiang

District,Dongguan,Guangdong,China